

CENTER LINE SECTION | looking south

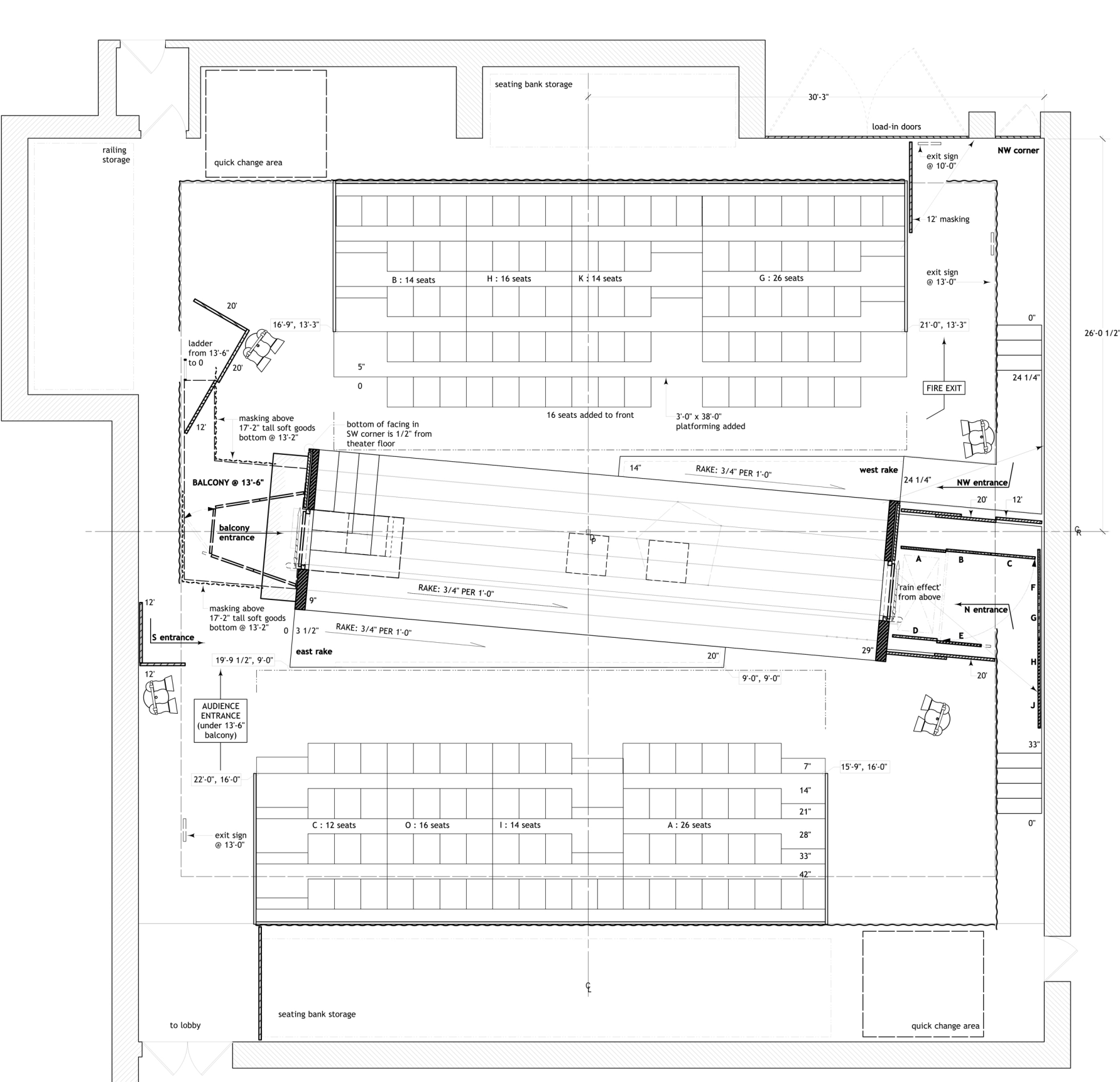

- DRAWING LIST:**
- 1 - ground plan & CL section looking south
 - 2 - front view looking west
 - 3 - platforms & rakes, off stage walls
 - 4 - walls
 - 5 - floor & ceiling
 - 6 - string house (11 x 17)
 - 7 - light bulbs (11 x 17)

NOTES:

CL & CR based on a DP; from the NW corner
26'-0 1/2" east to CR, 30'-3" south to CL

set & seating bank dimensions labeled as
x, y: x = distance to CL, y = distance to CR

main floor & side platforms are all raked 3/4" per 1'-0"
all platform heights are measured off of that rake
the origin is the bottom of facing in SW corner is 1/2" from theater floor
there is a 5" step that is consistent between the main & side areas

side rakes are carpeted, low-pile black auto carpet
wrap carpet over 5" facing

doors, lights, action the same on the north & south walls,
except for 'rain effect' - which is only behind the north wall

all 4 main units have 1/4" wide x 1/8" deep kerfs cut 1'-4" on center;
high gloss finish

all masking is black duvetyne

154 seats total, includes 16 extra seats on west bank

off stage walls are all from DEAD MAN'S CELL PHONE
1 is wall E; 2 is wall D; 3 & 4 are walls M, N; 5 is wall R;
6, 7, 8, 9 are walls F, G, H, J; 10 is wall A; 11, 12 are walls B, C; 13, 14 are walls Q, P

railing & seating bank storage shown/noted in alcoves,
whatever units do not fit in those space need to store
outside of the theater



NOTES:
 doors, lights, action the same on the north & south walls, except for 'rain effect' - which is only behind the north wall

'rain effect'
 twice during show there is a 'deluge' of 'rain' inside the north wall each time we see the beginning & end of the 60 second event the 'rain' is crushed cork from Maryland Cork Company

all 4 main units have 1/4" wide x 1/8" deep kerfs cut 1'-4" on center; high gloss finish

main floor & side platforms are all raked 3/4" per 1'-0"
 all platform heights are measured off of that rake
 the origin is the bottom of facing in SW corner is 1/2" from theater floor there is a 5" step that is consistent between the main & side areas

side rakes are carpeted, low-pile black auto carpet wrap carpet over 5" facing

all masking is black duvetyne

drafting reduced 50%

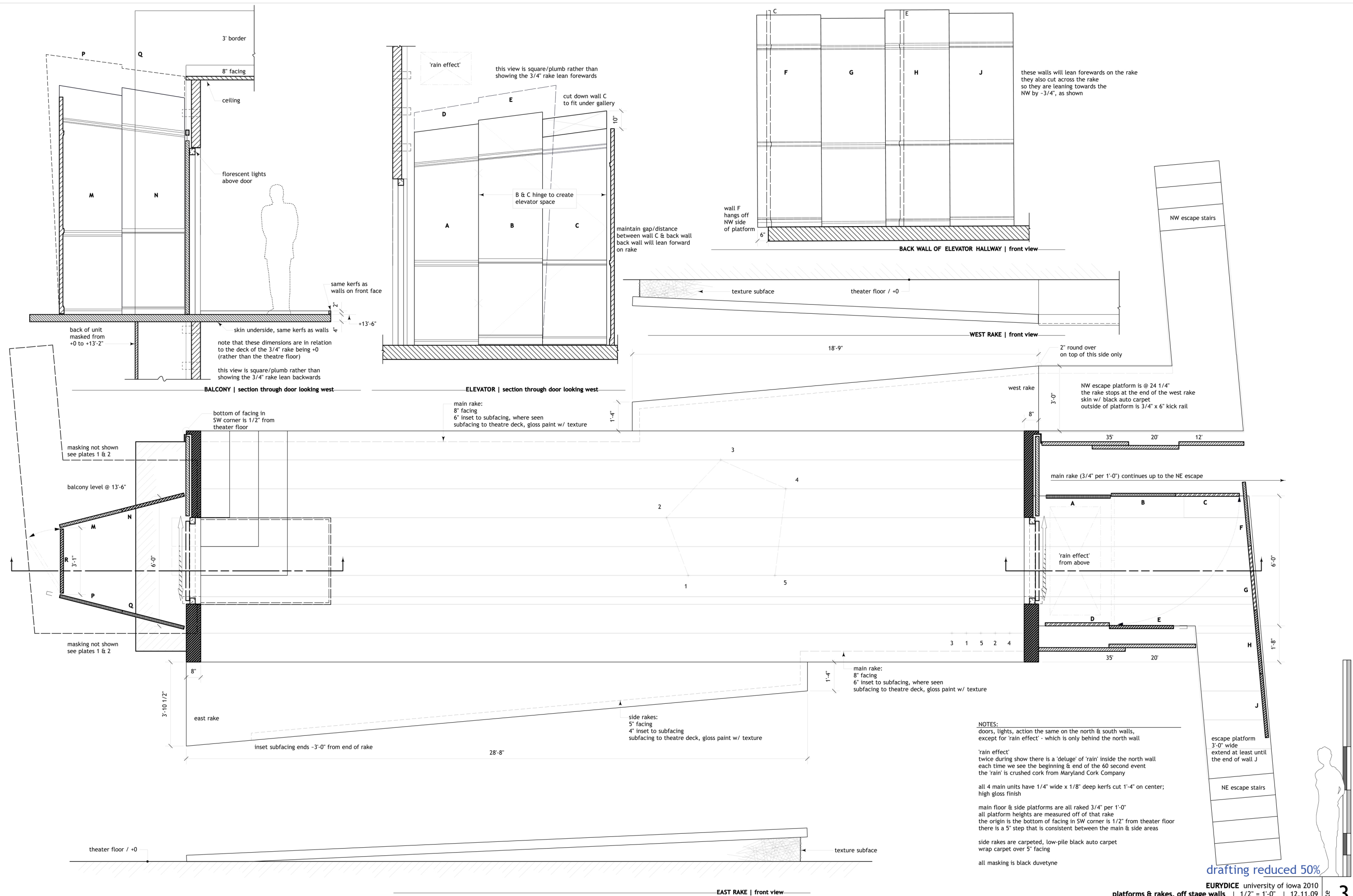

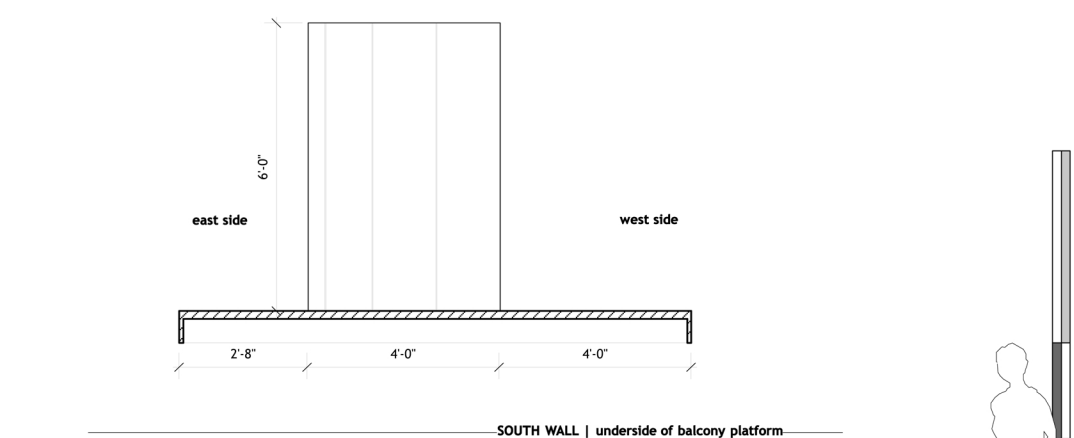
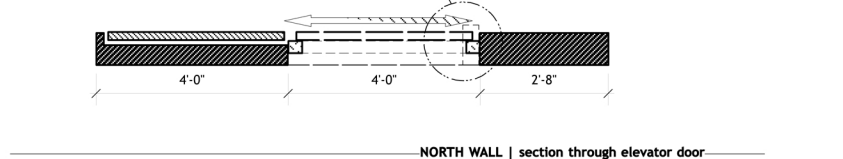
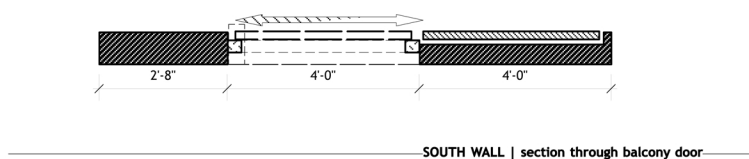

<p>EURYDICE university of iowa 2010 walls 1/2" = 1'-0" unless noted 12.11.09 sarah ballema, director r. eric stone, scenic designer</p>		<p>plate 4</p>
---	--	-----------------------

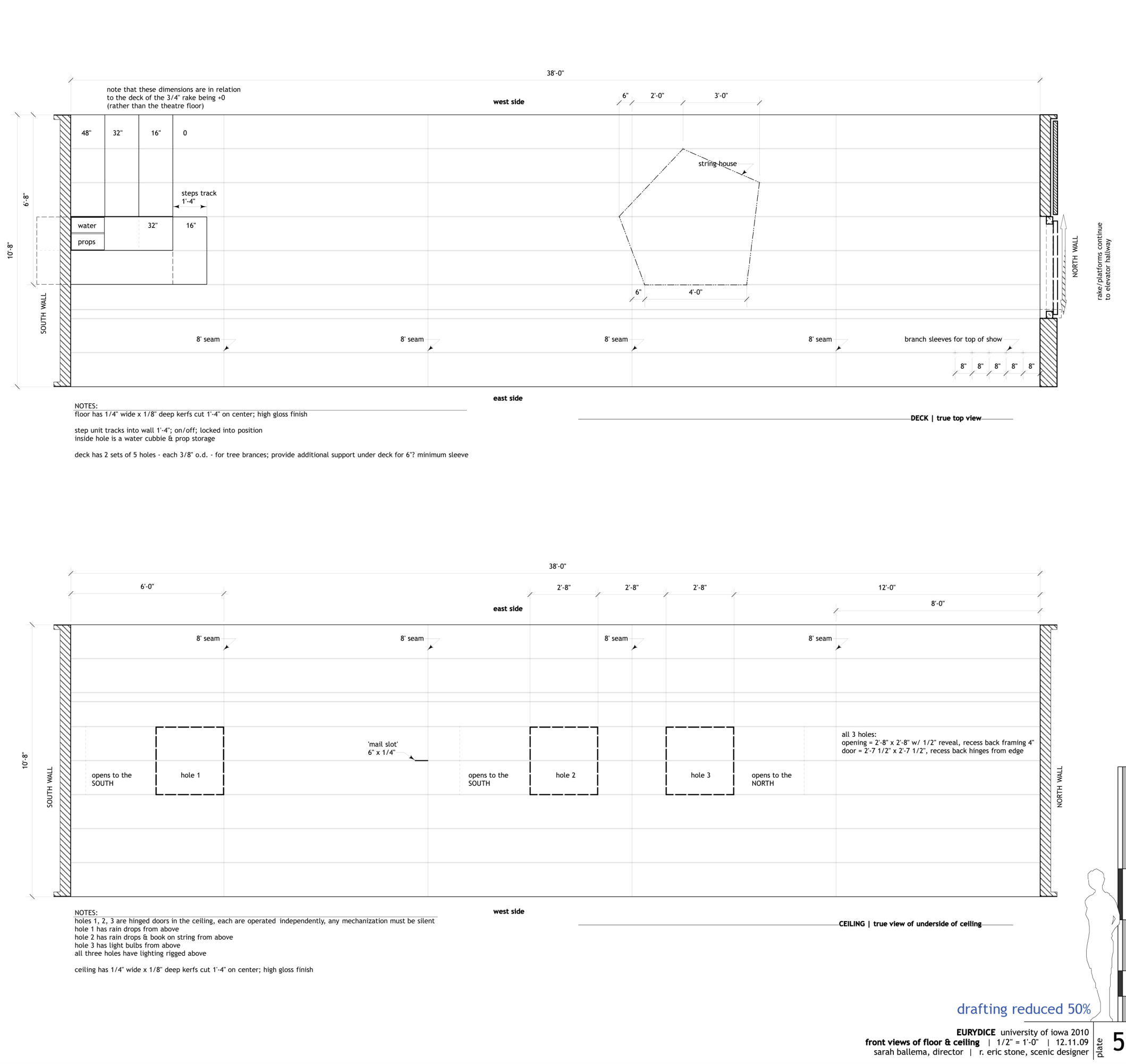
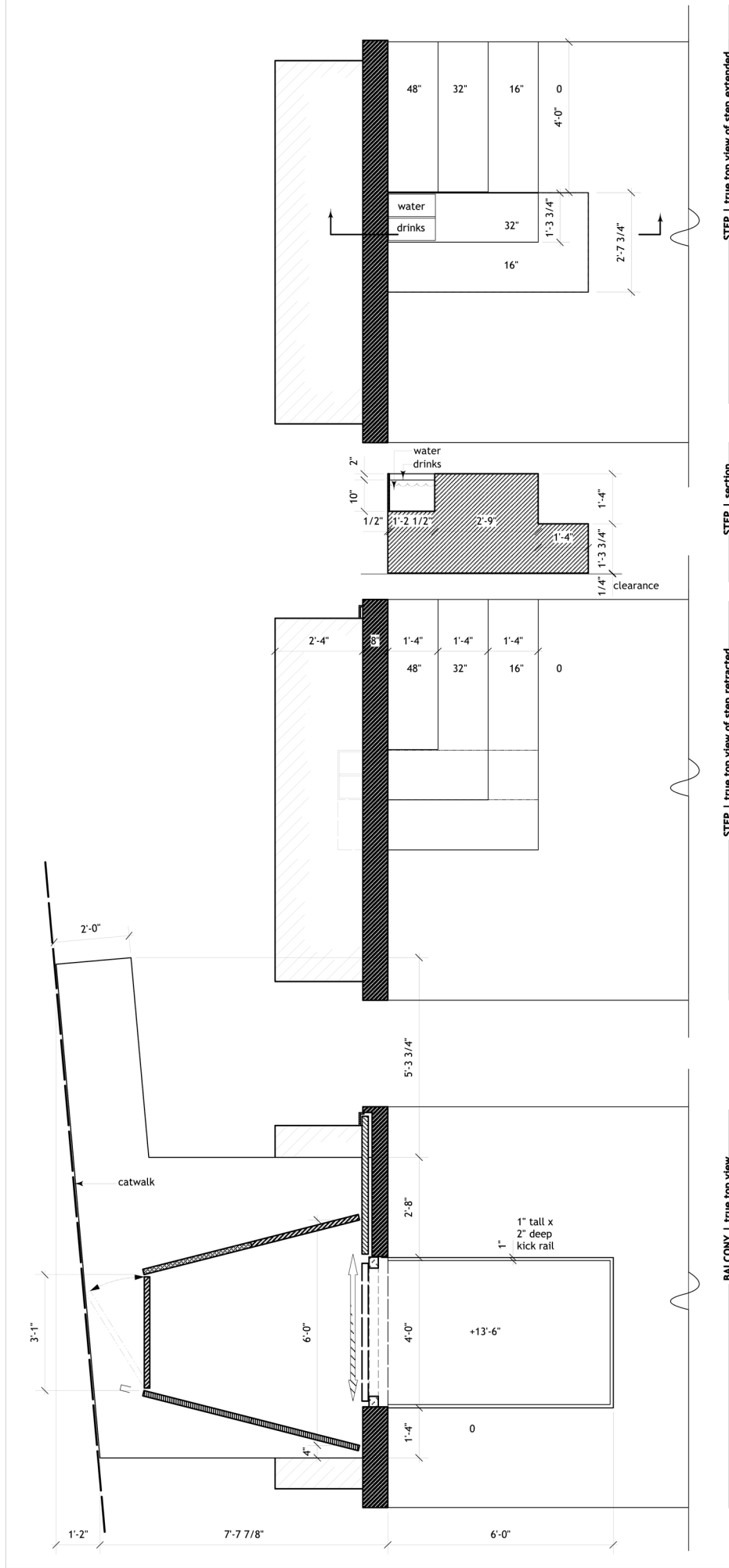

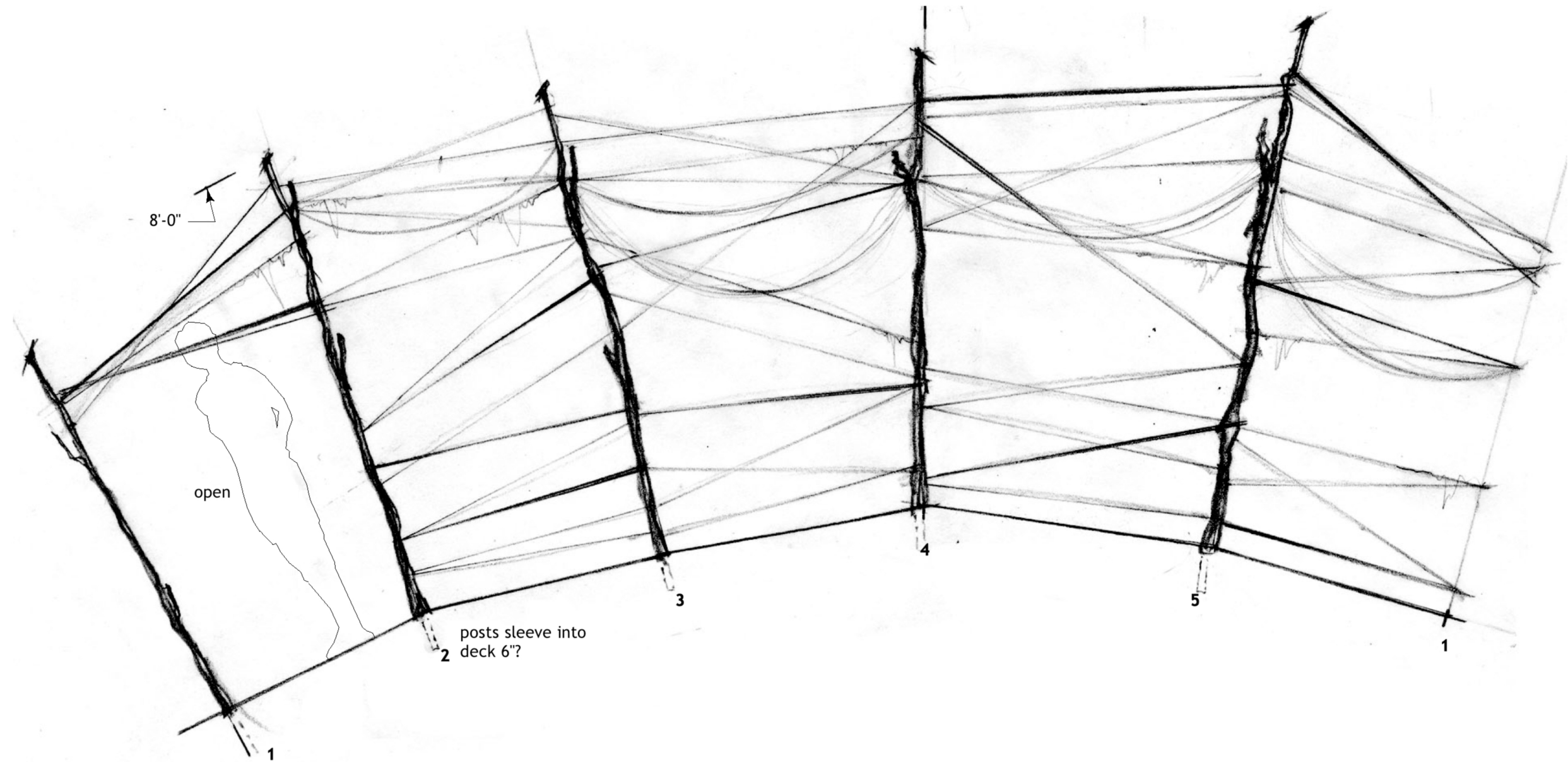

NOTES:

5 branches are realistic willow branches - no bark - many twists & barbs
 holes/sleeves are 3/8" o.d. w/ 6" sleeves
 branches are preset in 5 holes on the NE side of the main deck
 the father pulls them out individually, placing them in the 5 center holes
 lines between them are thick yellow string that is wrapped on stage each show
 the father wraps the string between the poles
 the father pulls all 5 poles (w/ string attached) & strikes unit through north wall door

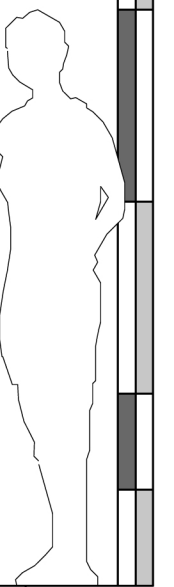

EURYDICE university of iowa 2010
string house | 1/2" = 1'-0" unless noted | 12.11.09
 sarah ballema, director | r. eric stone, scenic designer

plate

6

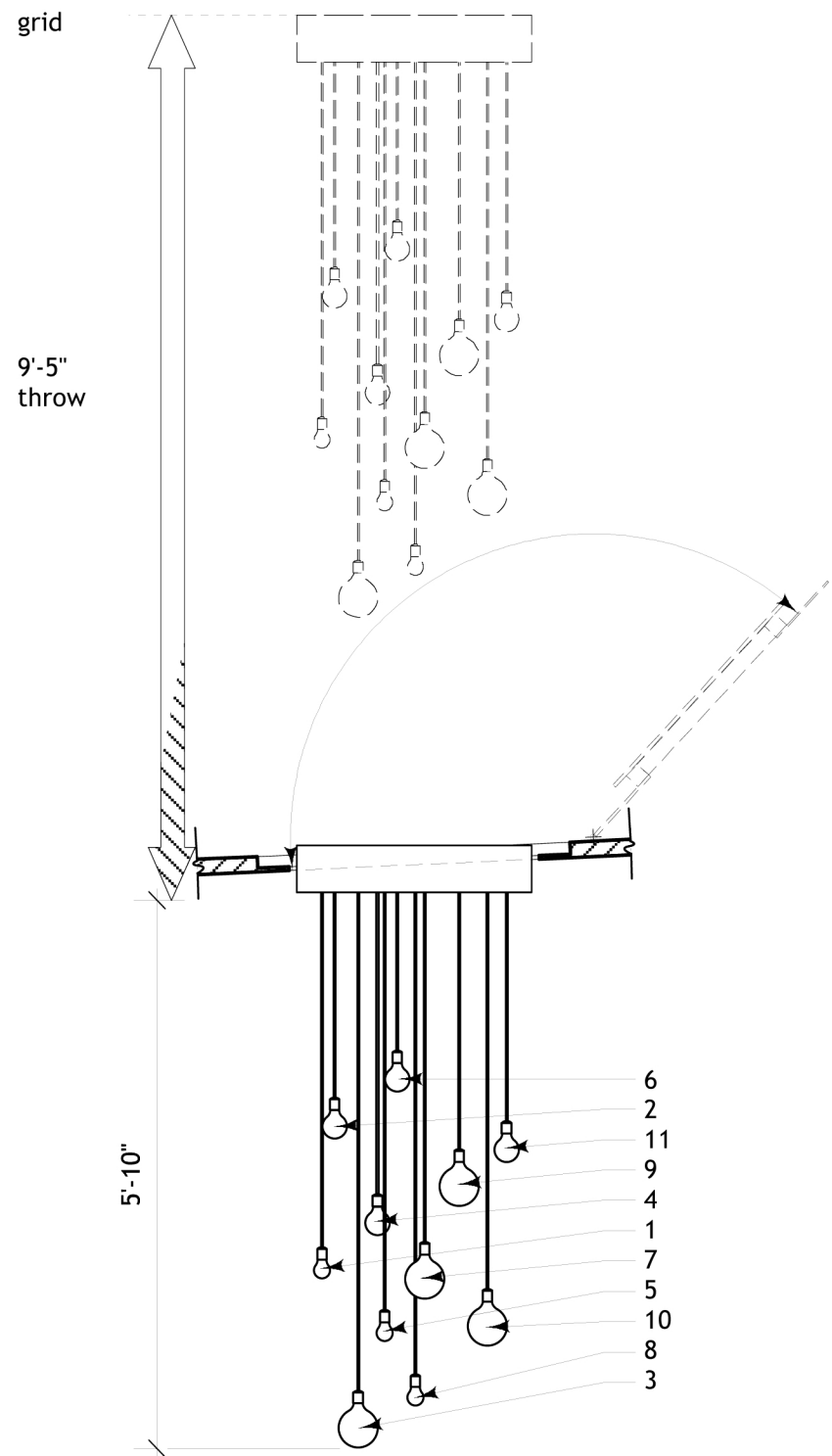

FRONT VIEW | looking west

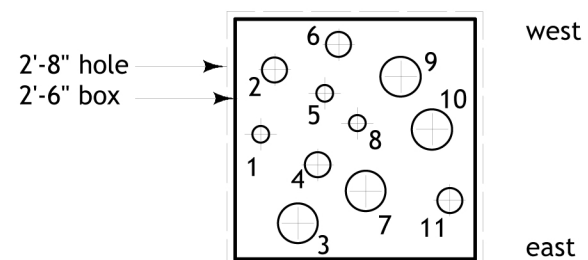

TOP VIEW

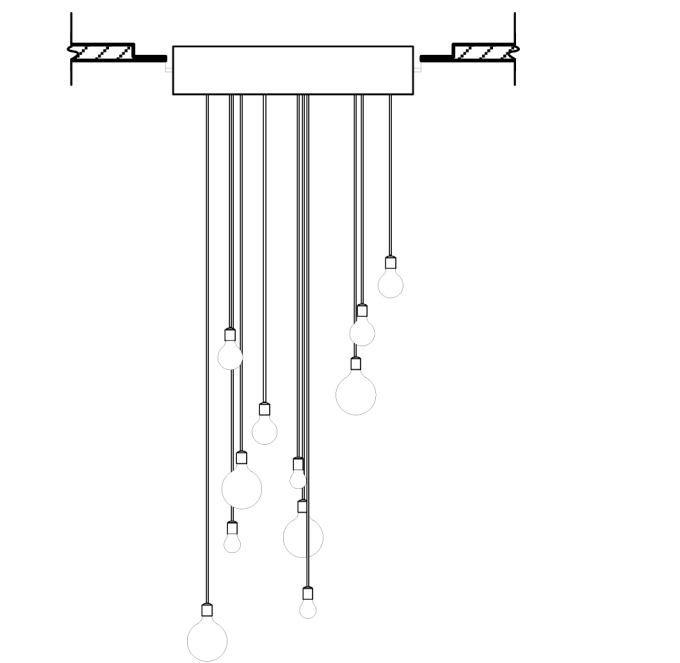

SIDE VIEW | looking south

NOTES:
 11 bulbs total
 3 small bulbs: G 16.5
 4 medium bulbs: G 25
 4 large bulbs: G 40
 black cord, straight as possible
 standard pull chain style sockets
 bulbs move together, 9'-5" throw
 box is high gloss blue (like floor)
 eric will assist on final height/placement of bulbs

